

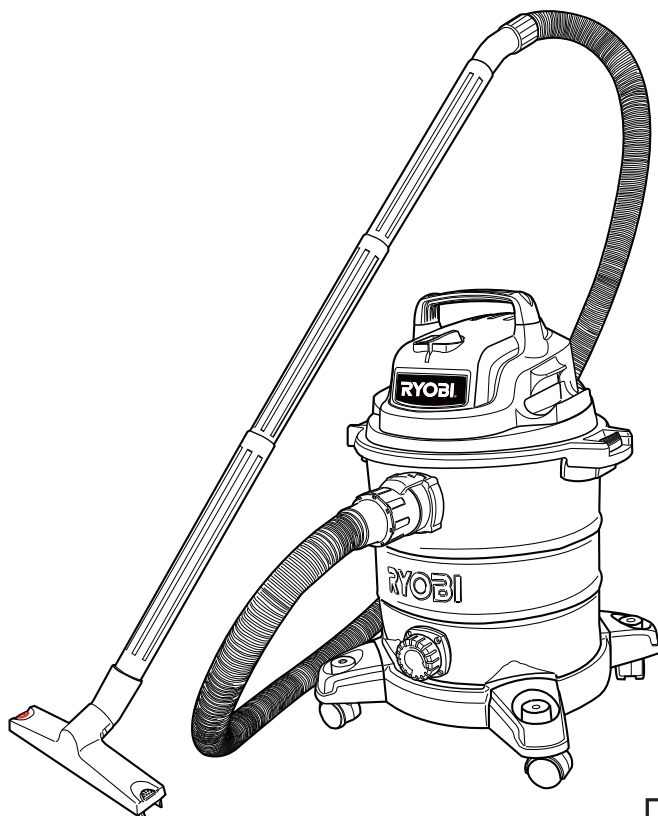

RVC-1220I-G

**WET AND DRY VACUUM CLEANER
OWNER'S OPERATING MANUAL**



DESCRIPTION

Components list

- | | |
|------------------------|-------------------------------------|
| 1. Extension Wand (x3) | 11. Filter basket |
| 2. Floor tool | 12. Safety float valve |
| 3. Crevice tool | 13. Cartridge filter cap |
| 4. Hose set | 14. Cartridge filter (non washable) |
| 5. Castor (x4) | 15. ON/OFF switch |
| 6. Handle | 16. Connection for the vacuum hose |
| 7. Foam filter | 17. Clamp (x2) |
| 8. Screws | 18. Tank |
| 9. Dust bag | 19. Drain outlet |
| 10. Blower connection | |

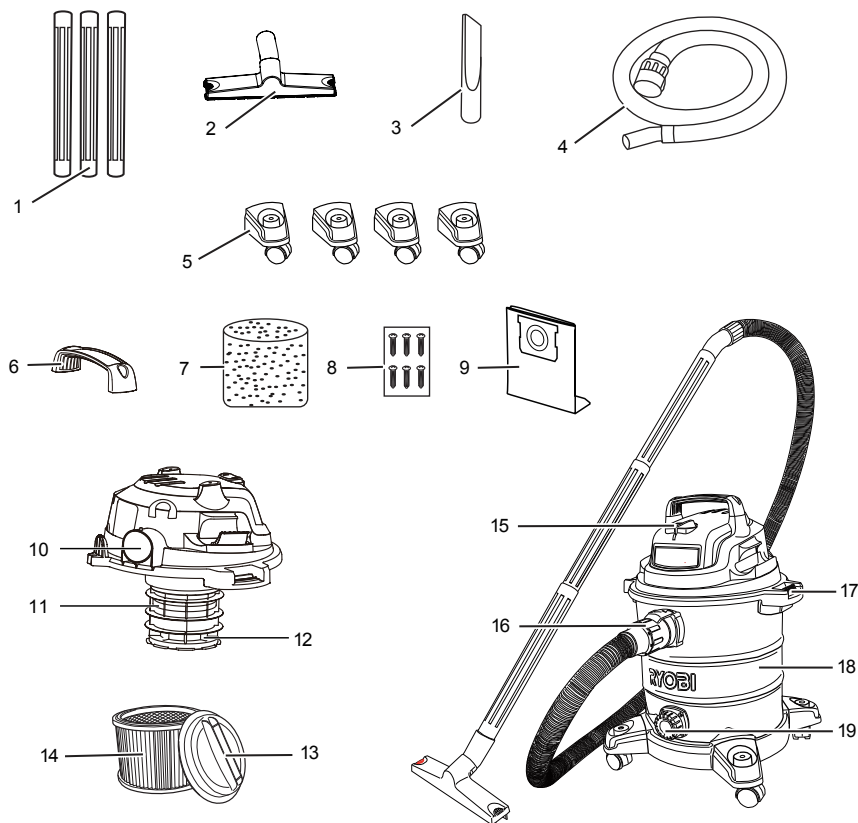
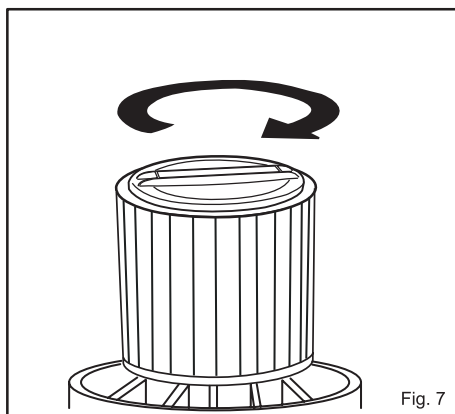
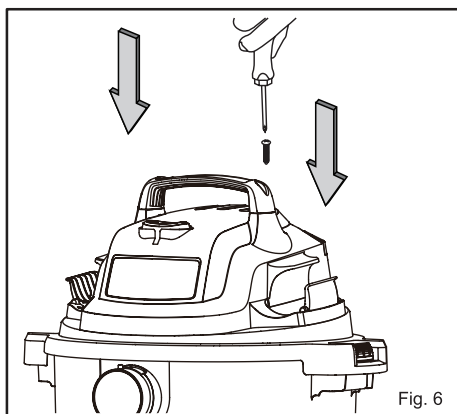
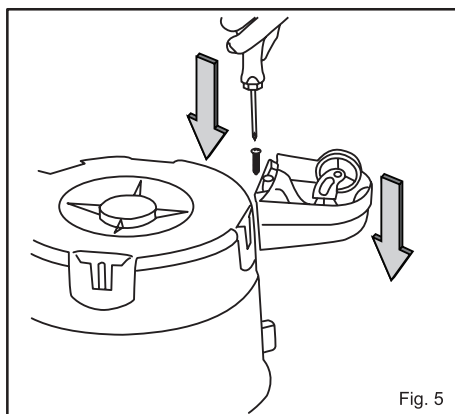
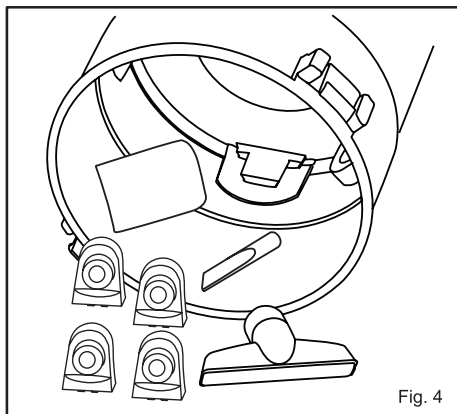
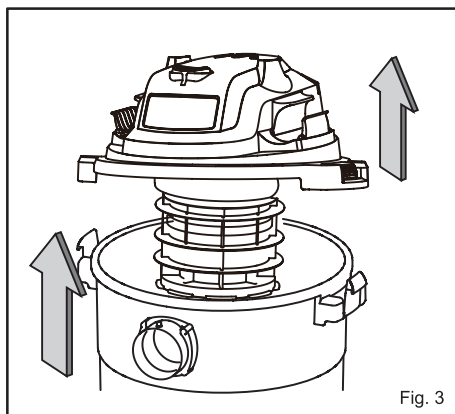
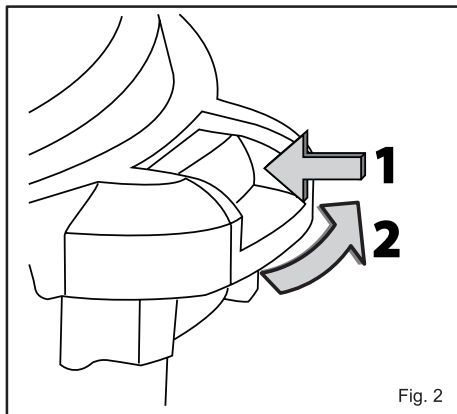

Fig. 1

DESCRIPTION



Please refer to pages 2 - 4 for instructions

DESCRIPTION

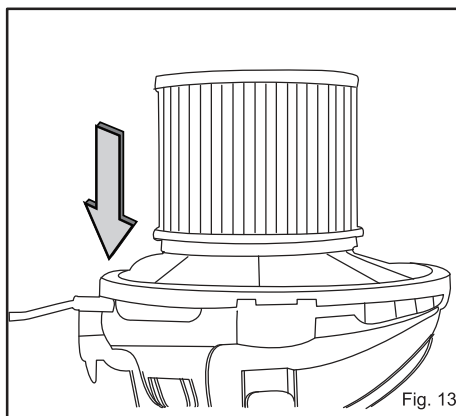
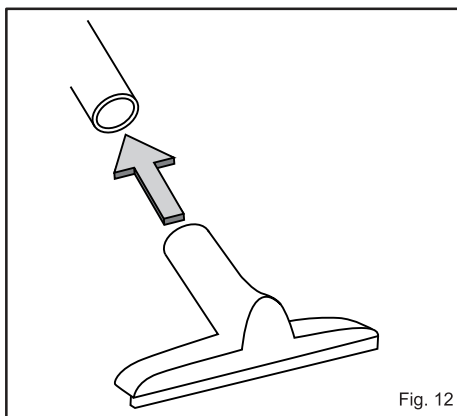
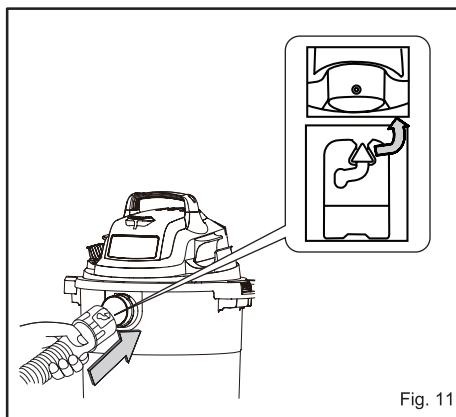
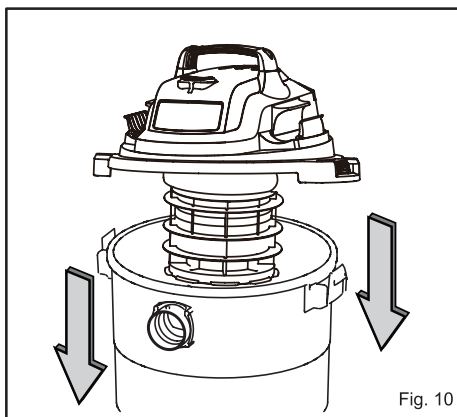
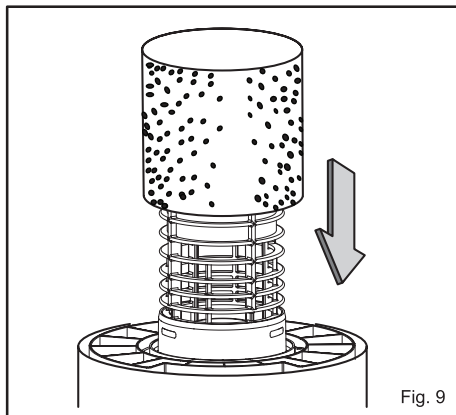
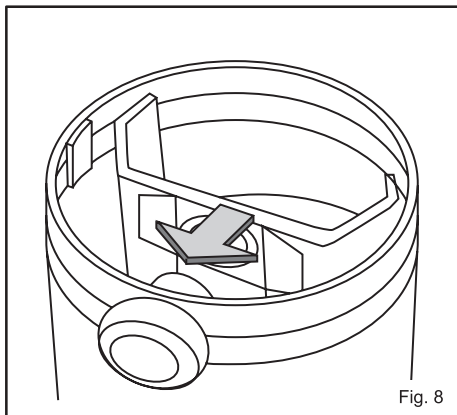

DESCRIPTION

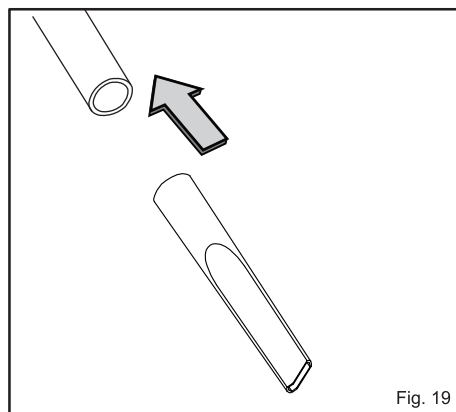
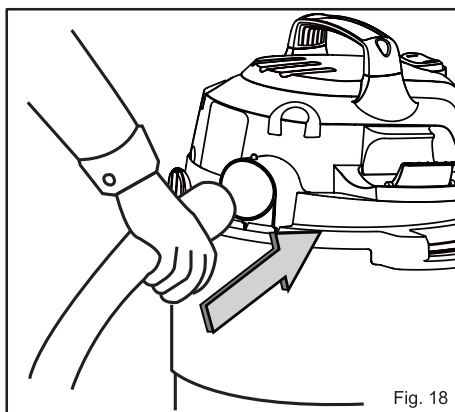
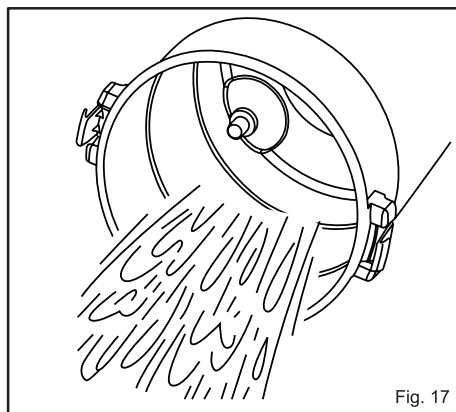
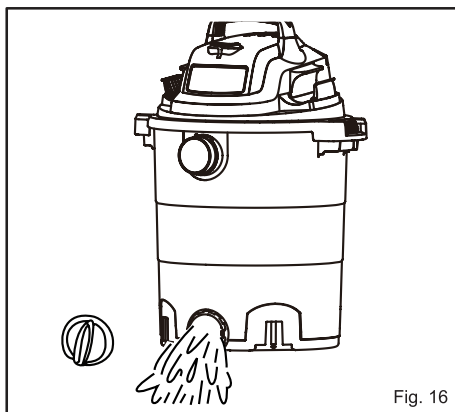
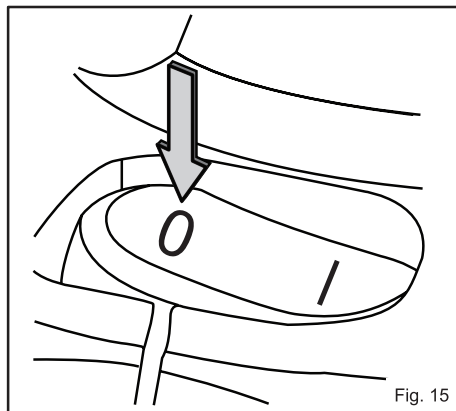
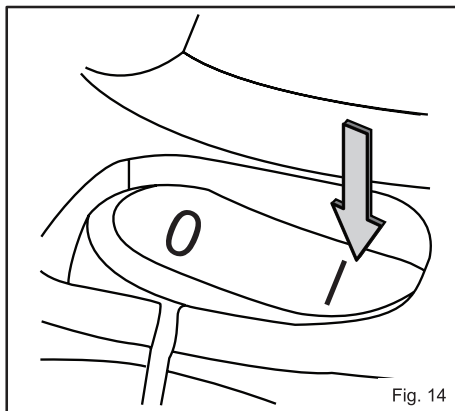

DESCRIPTION

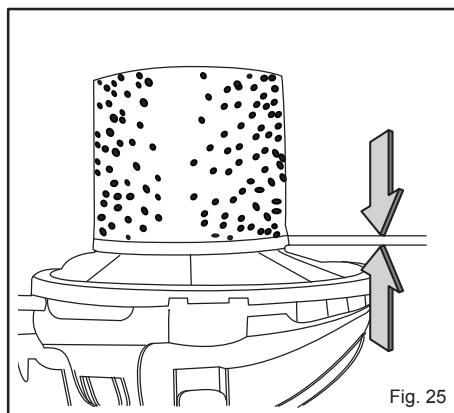
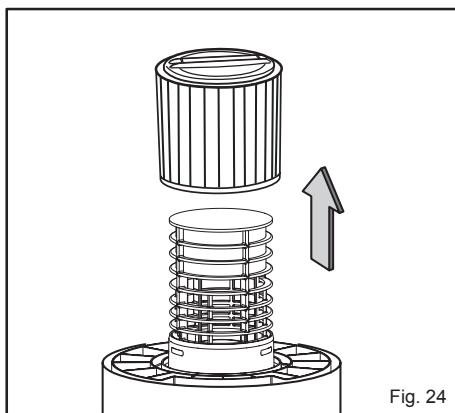
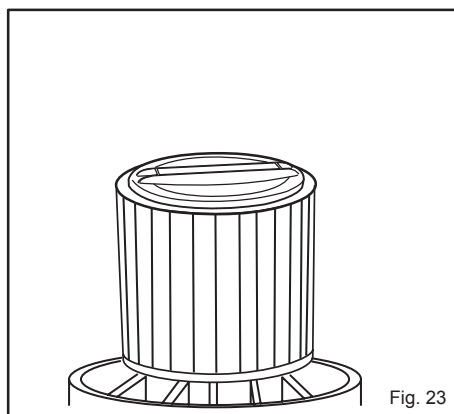
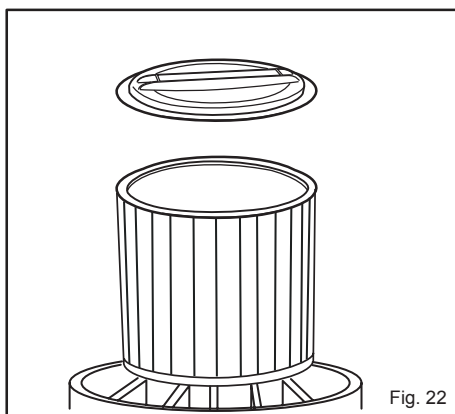
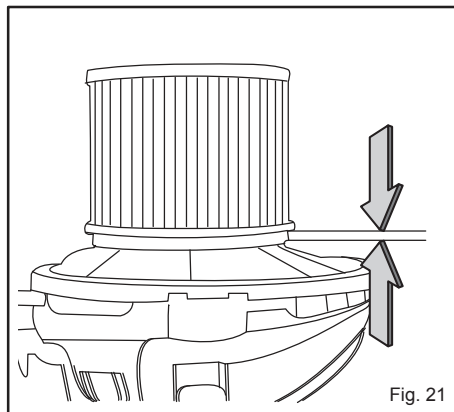
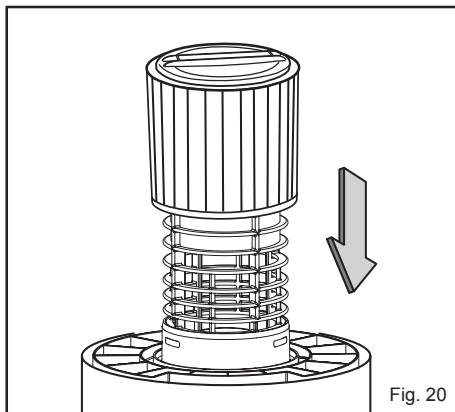

Please refer to pages 2 - 4 for instructions

DESCRIPTION

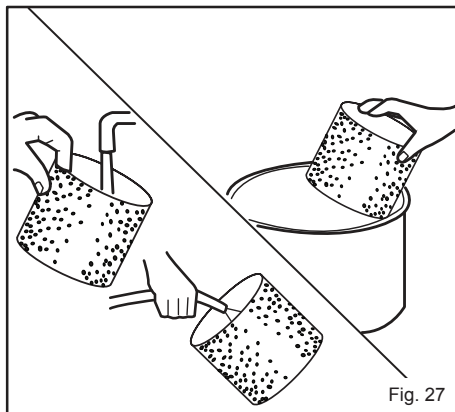
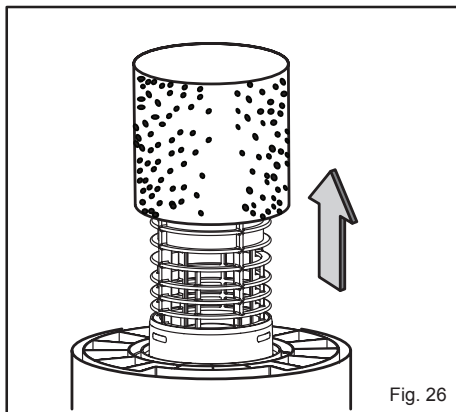

Important!

It is essential that you read the instructions in this manual before operating this machine.

Subject to technical modifications

GENERAL POWER TOOL SAFETY WARNINGS



WARNING!

This appliance complies with the compulsory safety regulations for electric equipment. However, improper use can be harmful to people and property. Please read these operating instructions carefully and completely before switching the appliance on. Keep the operating instructions, the guarantee certificate, the receipt, as well as the packaging and packaging material if at all possible.

- This appliance is designed solely for use in the private sector and for the designated purpose. The appliance is not suitable for commercial use. Don't use the appliance outdoors (unless it has been specifically designed for use outdoors). Don't subject the appliance to heat, direct sunshine or very high moisture (e.g., rain).
- Never immerse the appliance in liquids and be aware of sharp edges that may damage it. Never use the appliance with wet or damp hands. Unplug it immediately if the appliance becomes wet or damp when it is running. Don't immerse the appliance in water.
- This wet/dry vacuum cleaner may only be used and kept in a private home.
- The appliance is designed to vacuum up materials that are not hazardous to your health and that are not flammable.
- Never hold the connectors in front of your face (especially your eyes, ears, etc.). Never direct the nozzle towards persons or animals.
- Only use the appliance for its designated purpose. Any other types of use are at your own risk and are possibly dangerous.
- Other uses and unattended operation are not allowed.
- The manufacturer cannot be made responsible for damages that are caused by improper use or incorrect operation.
- Wear protective clothing and gloves.
- Connect the appliance only to a 230-240V alternating current receptacle.
- Make sure that the correct dust bag has been inserted securely in its holder before using the appliance. The wrong dust bag or incorrectly installed dust bags can cause damage to the appliance and cause the guarantee to become void.
- If the power cord is damaged, it must be completely replaced along with the cable protector by an authorised service centre or other qualified service organisation.
- Do not vacuum up ashes, hot coals and the like, large fragments of glass and sharp objects.
- Don't vacuum up any toner dust, which is used in printers and copiers for example, because it is electrically conductive. In addition, it is possible that it will not be completely filtered out by the filter system of the wet/dry vacuum cleaner and can be released into the air via the exhaust fan.
- Never vacuum flammable or poisonous liquids like petrol, oil, acids, or other volatile substances.

- Don't vacuum up liquids that are hotter than 60°C or any poisonous or flammable dusts.
- Never lay the appliance on its side. Pay particular attention to a horizontal position and adequate stability on stairs.
- Always unplug the appliance after use and before cleaning or changing the filters or accessories.
- Only trained specialists may make repairs on electric equipment. Improper repairs could result in considerable danger to the user.
- Do not store the appliance directly beside a hot oven or radiator.
- Children, disabled persons, and the aged are often not aware of the dangers that can result from handling electric appliances. The above mentioned persons and untrained persons must never work with this electrical appliance.
- When cleaning or removing the appliance, always switch it off. Pull the plug out of the receptacle, if you are not going to use the appliance for an extended period of time. Never pull on the cable to unplug the appliance, rather pull on the plug itself. Also, remove any special accessories from the appliance.
- Always keep the appliance clean. Don't use any solvents or cleaners that may damage or be harmful to the appliance or user.
- Never leave the appliance switched on unattended. If you leave the work area, switch the appliance off or unplug it from the receptacle (don't pull the cord, but use the plug).
- In order to protect children from electric household appliances, make sure that the cable can't cause children to stumble and don't give children access to the appliance.
- Never use the appliance when you are under the influence of medication, alcohol or drugs, if you are currently under medical care, or if you are tired.
- Check the appliance and the power cord regularly for any possible damage. Don't use damaged appliances.
- Don't try to repair the appliance yourself. Always use an authorized technician for repairs. Always have faulty power cords replaced immediately by the manufacturer or a qualified service organization. Use the same type of cable in order to prevent any danger of electric shock and injury.
- Only use original spare parts and accessories. Non approved parts or third-party accessories may be a possible source of danger and cause the guarantee to become void.
- Check the float often.
- If you notice liquid leaking from your appliance, switch it off immediately and unplug it.
- Do not submerge the appliance in water. Make sure that water is not spilled on the appliance.
- When disposing of the wastewater, make sure that you observe any legal regulations.

- Only store the appliance in a safe and dry location outside the reach of children.
- Please also pay particular attention to the following "Special Safety Rules".
- This appliance is not intended for use by persons (including children) with reduced physical, sensory or mental capabilities, or lack of experience and knowledge, unless they have been given supervision or instruction concerning use of the appliance by a person responsible for their safety.
- Children should be supervised to ensure that they do not play with the appliance.
- If the supply cord is damaged, it must be replaced by the manufacturer, its service agent or similarly qualified persons in order to avoid a hazard.
- Electrical power should be supplied via a residual current device (RCD) with a tripping current of not more than 30mA.
- Only use a weather proof extension cord. Check the extension cord before every use for damage. Always uncoil the extension cord during use because coiled cords can overheat. Damaged extension cords should not be repaired, they should be replaced with an equivalent type.
- **WHEN USING BLOWER FUNCTION:**
 - Direct air discharge at work area only – never at people or animals.
 - Do not use blower as a sprayer in wet mode.
 - Wear a dust mask and protective eye wear.

⚠ WARNING

Always switch off and unplug the machine from the electrical outlet before assembling, opening, emptying the dirt container, before connecting/disconnecting the attachments, or carrying out maintenance or troubleshooting checks.

IMPORTANT!

If the hose or tools are blocked, switch off the cleaner and remove the blockage(s) before re-starting your machine.

IMPORTANT!

Cleaning filters and replacing them regularly maintains vacuum performance. Vax recommends that your filters should be checked, cleaned and replaced periodically.

DAMAGE TO THE VACUUM CLEANER CAUSED AS A DIRECT RESULT OF NOT ADHERING TO THE GENERAL SAFETY INFORMATION AND THE INSTRUCTIONS IN THIS USER GUIDE INVALIDATES THE WARRANTY.

PLEASE KEEP THESE INSTRUCTIONS FOR FURTHER USE.

SPECIAL SAFETY RULES

- Never vacuum up hot ashes, pointed or sharp objects.
- Never use the appliance in damp rooms.

- Don't use the appliance without a dust bag (an exception is wet vacuuming or with the cartridge filter). Make sure that the dust bag is inserted into the appliance correctly.
- When using the appliance, make sure that no hair, clothing, or members are drawn in.
- Keep the vacuum cleaner away from heat sources such as radiant heaters, ovens, and so on.

DISPOSAL INFORMATION

- The appliance contains electric and electronic components and may not be disposed of as household garbage.
- The local and currently applicable legislation must be observed unconditionally.

SPECIFICATIONS

Supply voltage:	240V ~ 50Hz
Rated power:	1250W
Tank volume:	20L
Hose system:	Ø35mm
Filter - dry:	Cartridge filter
Filter - wet:	Foam filter
IP rating:	IPX4
Suction:	17kpa/2.47PSI
Cord length:	4m

PACKAGING CONTENT

See Fig. 2 - Fig. 4

- Carefully unpack the contents of the box.
- Hold the two clamps, which hold the upper section in its position and fold them upwards.
- Loosen the clamps, remove the upper section, and remove the contents from the tank.
- Please check the parts using the components list to make sure they are complete and that there has been no damage in transport.
- If any parts are missing or damaged, then please contact your dealer immediately.

ASSEMBLY

- Ensure that the power cord is disconnected from the power outlet.
- Undo the clamps (Fig. 2).
- Lift the top section off the tank (Fig. 3).
- Remove the contents from inside the tank (Fig. 4).
- Turn the tank upside down, and insert the casters on to the four feet of the tank. Ensure that they are mounted correctly. Do not over tighten (Fig. 5).

- Insert the handle into the slots on the power head and pressure into place (Fig. 6).
- For dry vacuum cleaning, install the supplied cartridge filter and dust bag (Fig. 7, Fig. 8).
- For wet vacuum cleaning, install the supplied foam filter (Fig. 9)
- Replace the top section on the tank (Fig. 10).
- Align the top section with the clamps and snap into place by applying pressure until clamps click (Fig. 10).
- Insert the large end of the hose into the front inlet of the tank and turn to lock (Fig. 11).
- Fit the required accessory on to the suction tube (Fig. 12).

OPERATION

DRY VACUUMING

WARNING

Ensure that you read, understand, and apply the safety instructions.
Reminder: DO NOT vacuum hazardous substances. The use of an incorrect dust bag will invalidate the warranty.

- Ensure that the power cord is disconnected from the outlet.
- Ensure that the cartridge filter is completely mounted. Ensure that the filter is inserted all the way. (Fig. 13)
- Verify that the dust bag is installed to the inside of the tank (Fig. 8).
- Replace the top section on the tank, and secure it in place using the clamps (Fig. 10).
- Insert the larger end of the hose into the front inlet on the tank and lock it in place. Push the required attachment on to the free end of the hose or extension (Fig.12).
- Plug the power cord in to the power outlet.
- Turn the motor on by flipping the switch to the 'I' (ON) position (Fig. 14).
- Once you have finished vacuuming, flip the switch to the 'O' (OFF) position and unplug the power cord from the power outlet. (Fig. 15)

WARNING

DO NOT USE THE CARTRIDGE FILTER FOR WET OR SHARP MATERIALS.
DO NOT USE DUST BAG FOR LIQUID VACUUMING.

WET VACUUMING

WARNING

Ensure that you read, understand, and apply the safety instructions.
Reminder: DO NOT vacuum hazardous substances.

- Ensure that the power cord is disconnected from the power outlet.
Ensure that the tank is clean and free of dust and dirt.
- Remove the cartridge filter and dust bag, and install a foam filter over the filter basket and place the top section back on the tank (Fig. 9).
DO NOT use the cartridge filter for wet or sharp materials.
- Fit the desired nozzle to the vacuum hose (Fig. 12).
- Ensure that the switch is in the 'O' (OFF) position before plugging the power cord into the power outlet.
- Turn the motor on by flipping the switch to the "I" (ON) position (Fig. 14).
- After use, flip the switch to the "O" position (Fig. 15) and unplug the power cord, then empty and dry the tank (Fig. 16, Fig. 17).

WARNING

The foam filter must be removed after wet vacuuming, and a cartridge filter must be installed before dry vacuuming again.

IMPORTANT!

When vacuuming large quantities of liquids, do not immerse the nozzle completely in the liquid; leave a gap at the tip of the nozzle opening to allow air inflow.

The machine is fitted with a float valve that stops the suction action when the container reaches its maximum capacity. You will notice an increase in motor speed. When this happens, turn off the machine, disconnect from power supply, and drain the liquid into a suitable receptacle or drain. To continue vacuuming, refit the container with the drain cap. After wet vacuuming, turn the machine off and remove plug from power supply.
Empty the container, clean and dry the inside and outside before storage.

BLOWER OPERATION

This Wet/Dry Vac has blowing capabilities.
To use the blower feature follow the instructions listed.

WARNING

Always wear safety goggles before using blower.

WARNING

Keep bystanders clear from blowing debris.

WARNING

Wear a dust mask if blowing creates dust that might be inhaled.

- Insert the large end of the hose into the blower connection in the top of the motor housing (Fig. 18).
- Fit the crevice to the vacuum hose (Fig. 19).
- Ensure the power switch is turned off and plug in the power supply.
- Turn the motor on by flipping the switch to the "I" (ON) position (Fig. 14).

- The unit will now blow through the vacuum hose and can be used to clear obstructions within the hose.
- Once you have finished operation, flip the switch to the 'O' (OFF) position and unplug the power cord from the power outlet. (Fig. 15)

WARNING

If after a few seconds the hose continues to be blocked, turn off the unit and clear the hose manually.

MAINTENANCE

INSTALLING AND CLEANING THE DRY FILTER

NOTE: Unplug machine from the power outlet before performing maintenance.

Installing Dry Filter

- Install the dry filter over the filter cage with the flat end of the filter towards the vacuum power head. Carefully push filter in until it stops against the power head. (Fig.20 & 21)
- Place filter retainer on top of cartridge filter over the raise lip and tighten down by turning retainer clockwise, do not over tighten. (Fig. 22 & 23)

Removing And Cleaning Dry Filter (THIS FILTER IS NOT WASHABLE)

- Unlock and remove the filter retainer by turning retainer handle anticlockwise.
- Carefully hold and pull the dry filter up for removal. (Fig. 24)
- Clean the cartridge filter by gently tapping or brushing dirt off. For optimal performance it is recommended to regularly change this filter depending on level of use (eg. 3-6 months).
- Install cleaned or new filter into place as instructed above.

INSTALLING AND CLEANING THE FOAM FILTER

NOTE: Unplug machine from the power outlet before performing maintenance.

Installing Foam Filter

- Follow instructions to remove dry dust filter first before changing to foam filter.
- Carefully slide foam filter down over the filter cage making sure the whole cage is covered. (Fig. 9 & 25)

Cleaning Foam Filter

- Carefully remove foam filter. (Fig. 26)
- Use a mild soap and water solution to wash foam filter and rinse with clean water. (Fig. 27)
- Allow filter to air dry before installing and using again.

ENVIRONMENTAL PROTECTION



Recycle raw materials instead of disposing of as waste. The machine, accessories and packaging should be sorted for environmental-friendly recycling.

SYMBOL



Safety Alert

V

Volts

Hz

Hertz

~

Alternating Current

W

Watts



Regulatory Compliance Mark (RCM).
Product meets applicable regulatory requirements.



Please read the instructions carefully before starting the machine.



Class II equipment



Recycle



Waste electrical products should not be disposed of with household waste. Please recycle where facilities exist. Check with your Local Authority or retailer for recycling advice.

⚠ WARNING

To reduce the risk of personal injury, unplug the cleaner before performing maintenance/troubleshooting checks.

Problem	Cause	Solution
The appliance doesn't work	No power	Check the power supply.
	Functional fault in the power cord, switch, or motor	Have the damaged part checked by qualified personnel or replace it.
	Tank is full of liquid	Empty the tank
Dust is escaping from the motor cover	The dust bag is missing or damaged	Put in a dust bag or replace it.
Low suction power and high motor speed / vibrations	Dust bag is full	Replace the dust bag
	Suction nozzle, hose, or tank inlet is blocked.	Check the suction nozzle, hose, and tank inlet for obstructions.

Techtronic Industries (Australia) Pty. Ltd.
31 Gilby Road,
Mt. Waverley, VIC 3149, Australia

Techtronic Industries New Zealand Ltd.
2 Landing Drive, Auckland Airport,
Mangere, New Zealand 2022